

INSTRUCTION SHEET - CUP STATION ADAPTER PARTS

These factory-installed adapter parts on the right hand side of the cup station (#2 cup mechanism) are recommended when vending cup sizes smaller than 9 ounces. If you are vending cup sizes larger than 9 ounces, remove the parts as follows:

1. Remove the chute adapter assembly - R.H. (6231413) by removing the wing nut (3103133), as shown.
2. Remove the deflector adapter - R.H. by gently pressing against the bottom lip and pulling it straight up, as shown. NOTE: Do not bend the .50" legs on the deflector adapter when removing. This part is designed to be a snap fit (spring loaded).

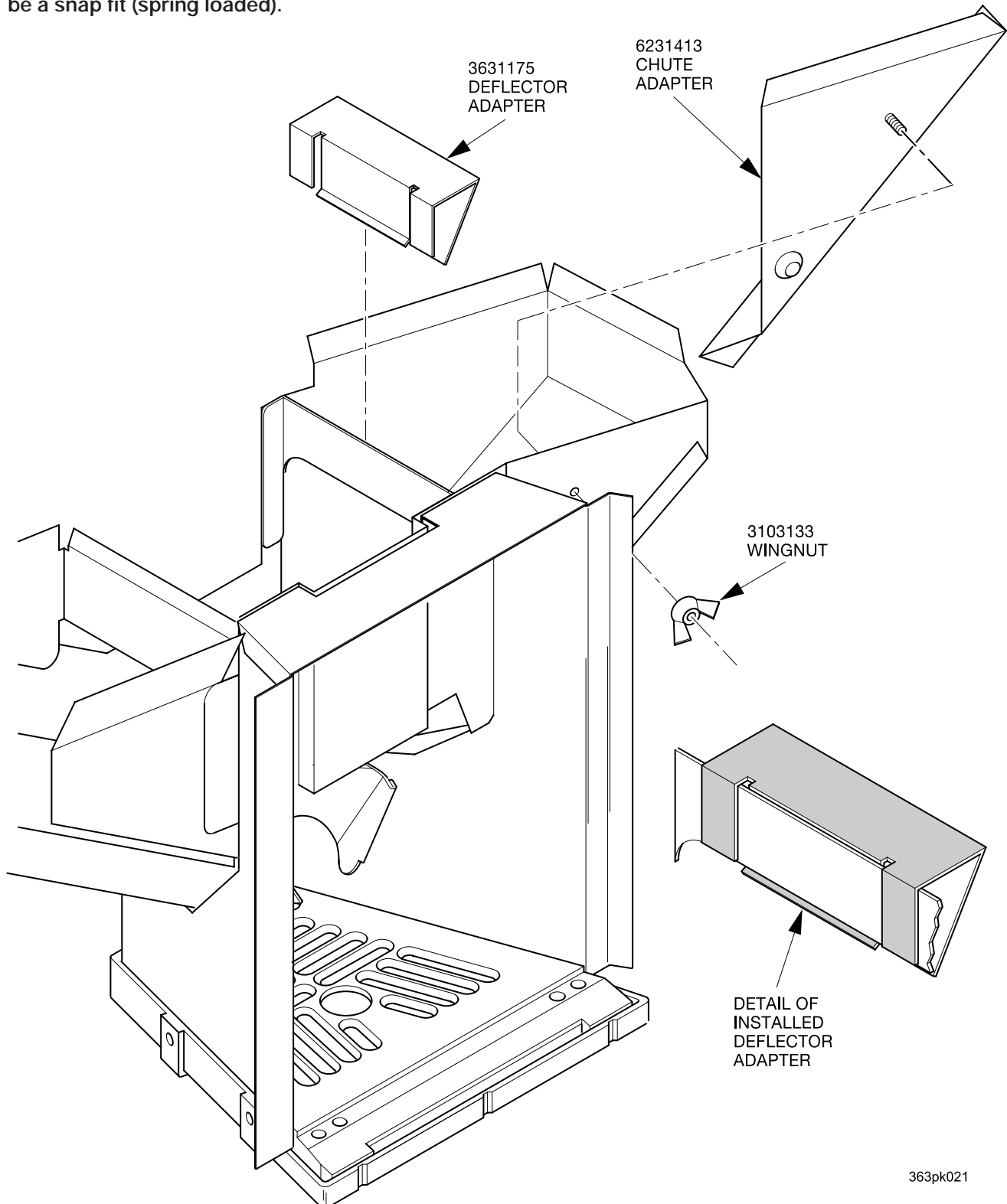

363pk021

3630066

CUP CHUTE ASSEMBLIES FOR SMALL CUPS

The default factory cup configuration is to vend 12 oz. cups. To aid you in dispensing smaller sizes of cups, the National Vendors Parts Department is offering two cup chute assemblies. These chutes can be attached to the #1 cup mechanism to improve successful delivery of smaller cup sizes.

The part numbers are:

- **3633026 - WELD ASSEMBLY - CUP CHUTE 5/7 OZ.** (for vending 5 - 7 ounce. cups).
- **3633030 - WELD ASSEMBLY - CUP CHUTE 8/12 OZ.** (for vending 8 - 12 ounce.

cups).

The appropriate chute assembly is attached to the bottom of the cup ring with 3 screws (**3128092 - SCREW - HILO - 7-19 X 3/8**), as shown.

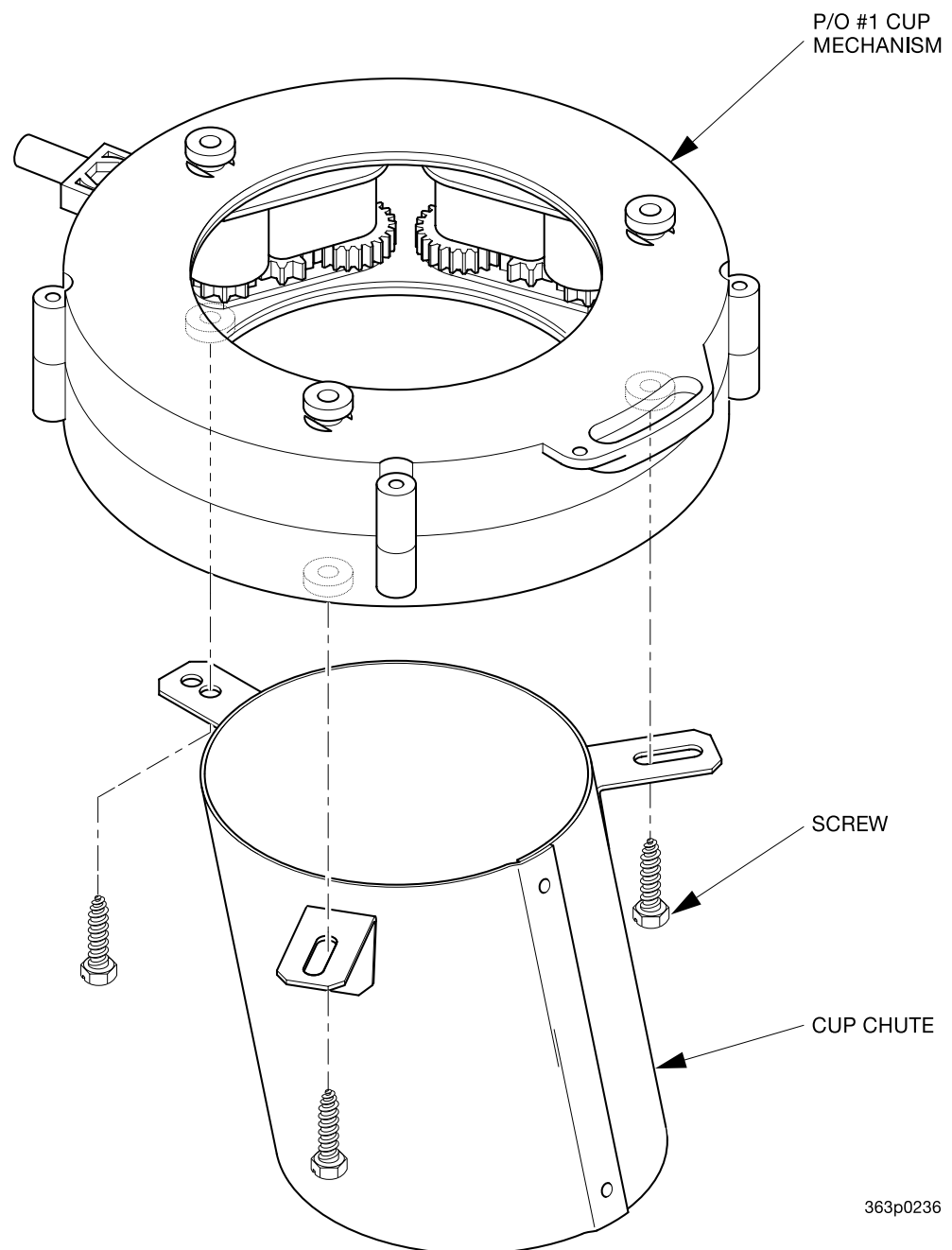

363p0236

3630066